INSTRUCTIONS

IMPORTANT SAFEGUARDS

When using electrical equipment, basic safety precautions should always be followed including the following:

1. **READ AND FOLLOW ALL SAFETY INSTRUCTIONS**
 2. Disconnect power before performing work on electrical equipment.
 3. Do not use outdoors.
 4. Use caution when servicing batteries.
 5. Equipment should be mounted in locations and at heights where unauthorized personnel will not readily subject it to tampering.
 6. The use of accessory equipment not recommended by Beluce Canada Inc., may cause an unsafe condition, and will void the unit's warranty.
 7. Do not use this equipment for other than its intended purpose.
 8. Servicing of this equipment should be performed by qualified service personnel.
 9. **SAVE THESE INSTRUCTIONS!**
-

INSTALLATION

WALL MOUNT - SINGLE FACE:

1. Extend unswitched 24 hour AC supply of rated voltage to junction box or appropriate wiring (supplied by others). Leave at least eight (8) inches of slack wire. The circuit should not be energized at this time.
2. Open the faceplate by removing screw from underside of faceplate (Figure 1). Tilt out the bottom of the faceplate, lift and remove (Figure 2).
3. Remove the universal canopy kit from inside the sign (if located there).
4. Knock out the appropriate mounting pattern and/or wire pass-thru hole on the back plate to fit the junction box or wiring connector being used (supplied by others).
5. Bring the wires through the back of the sign and mount the sign securely in place. Screw directly to the junction box if possible.
6. Connect AC supply per diagram provided (Figure 5). **Insulate unused wire!**
CAUTION! - Failure to insulate unused wire may result in a shock hazard or unsafe condition as well as equipment failure.
7. Route wires and secure them in place.
8. Position the pictogram between the posts on the inside of the faceplate and secure with 6 push nuts. (Figure 3)
9. Replace reflector inside housing (Figure 6).
10. Re-install faceplate and secure with screw.
11. Turn on the AC voltage supply.

CEILING/END MOUNT - SINGLE OR DOUBLE FACE:

1. Follow steps 1 to 4 of Wall Mounting instructions above.
2. On the top and side of the sign there are holes for the canopy. Knock out the appropriate canopy mounting holes for your installation.
3. Secure the canopy to the sign using the supplied nut and align the wire pass-thru hole in the frame to the wire pass-thru hole in the centre of the canopy.
4. Bring wires through the wire pass-thru and connect AC supply as described in step 6 of Wall Mount instructions above.
5. Secure the sign to the wall or ceiling using the supplied 1-1/2 inch screws and nuts. Screw directly to junction box if possible. A universal spider plate is supplied to allow for sign placement adjustment or connection to a variety of electrical boxes (Figure 4).
6. Follow steps 7 to 11 of Wall Mount instructions above.

Figure 1

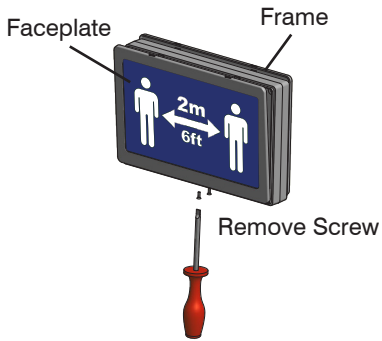

Figure 2



Figure 3

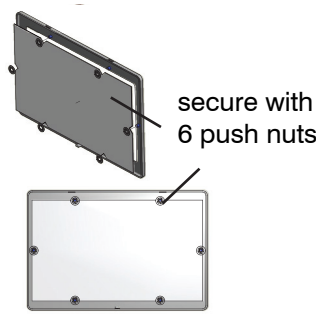

Figure 4

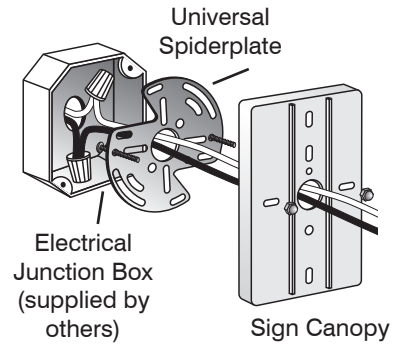

Figure 6

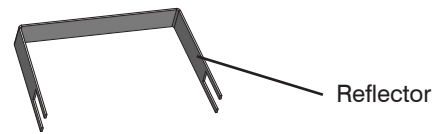
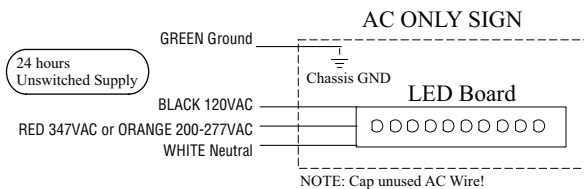

Figure 5



MAINTENANCE

- Code requires that the equipment be tested every 30 days for 30 seconds, and that written records be maintained. Further, the equipment is to be tested once a year for the duration required as per Code. The equipment is to be repaired whenever the equipment fails to operate as intended during the duration test. Written records of test results and any repairs made must be maintained. Beluce Canada Inc. strongly recommends compliance with all Code requirements.
 - Clean pictogram face(s) on a regular basis.
- NOTE: The servicing of any parts should be performed by qualified service personnel only. The use of replacement parts not furnished by Beluce Canada Inc., may cause equipment failure and will void the warranty.

TROUBLESHOOTING

SIGN DOES NOT COME ON AT ALL

- Check AC supply and all AC connections - be sure sign has 24 hour AC supply (unswitched).
- Check supply voltage and AC connections. The AC supply must be at least 80% of nominal (96V on a 120V line) for equipment to function normally. At lower voltages the LEDs will begin to glow dimly until the source voltage drops below the full "turn-on" point.

NOTE: This condition may also be caused by incorrectly connecting a 120 Volt supply line to the 277-Volt capacitor assembly lead.

- AC supply is OK; replace LED circuit board assembly.

SAVE THESE INSTRUCTIONS